

Engraving Pen

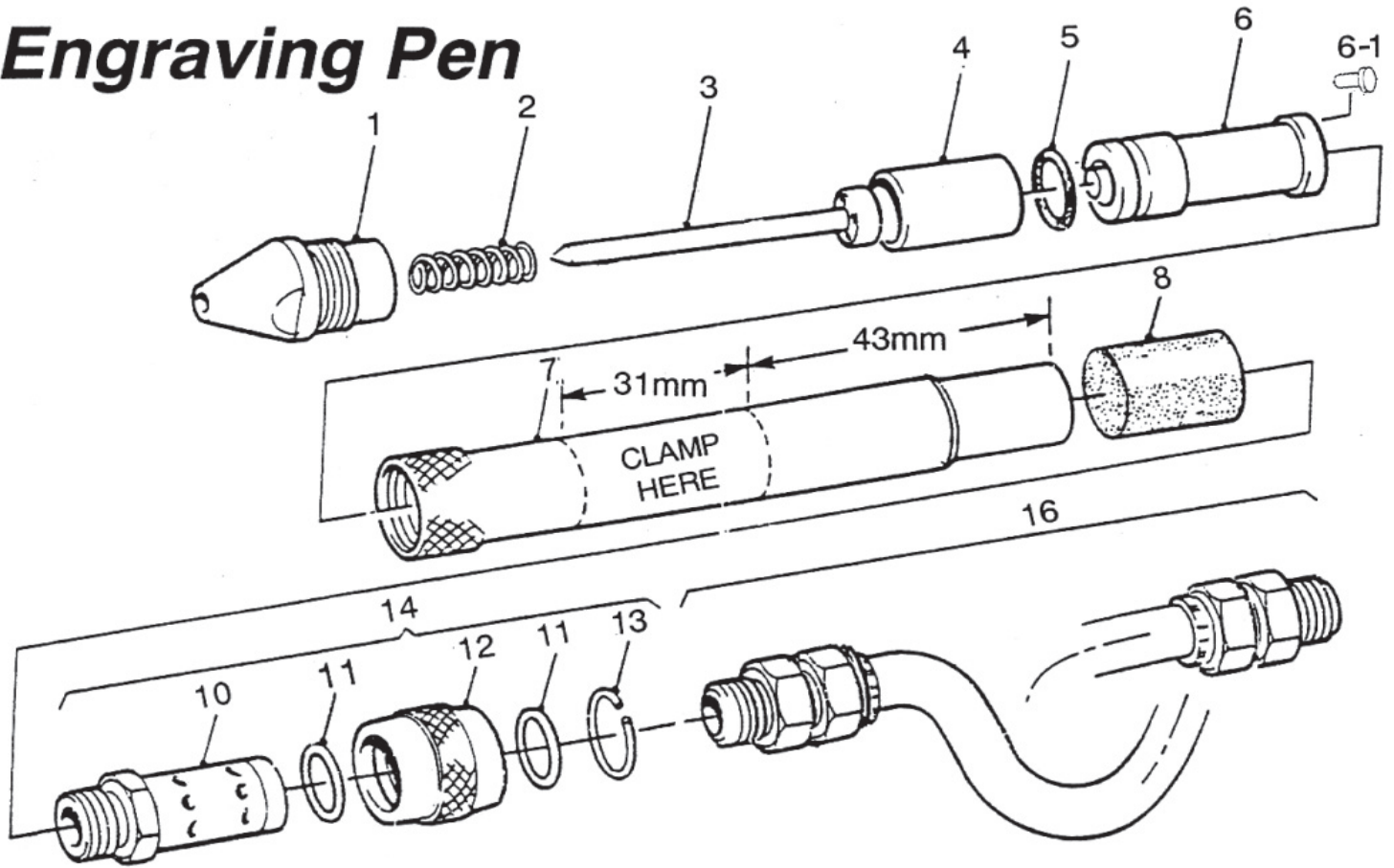

MAXIMUM WORKING PRESSURE: -4.1 bar. (60 lbf. in²).

OPERATION

Check that the outer sleeve of the On/Off Valve is at the top of its travel: the "OFF" position.

Connect the tool to an air supply, the pressure of which should be set between 2.75 and 4.1 bar. (40 and 60lbf.in²).

Switch on the tool and carry out a trial operation. The air supply pressure should be adjusted to suit the material being worked; bearing in mind that tool life will be extended if an acceptable result can be obtained on a lower air pressure.

For consistent performance the tip of the stylus must have a sharp point.

MAINTENANCE

Position clamp blocks, in the position shown, on the body, and clamp in vice.

Unscrew nose and withdraw spring, stylus and distance tube.

Unscrew the on/off valve and withdraw the air filter. Using a length of rod push lightly through the air inlet to remove the cylinder and piston assembly.

The tip of the stylus can be reground using a Green Silicone Carbide stone and grinding to an angle of 60°inc.

Clean the components, replace parts as necessary, then assemble the tool, noting that the nose should be tightened to a torque of 4.3Nm (38lbf.in.)

PARTS LIST

No.	Parts No.	Description	Q'ty
1	909-01	Nose	1
2	909-02	Spring	1
3	909-03	Stylus	1
4	909-04	Distance Tube	1
5	909-05	"O" Ring	1
6	909-06	Cylinder & Piston Assembly	1
6-1	909-06-1	Spindle Of Cylinder	1
7	909-07	Body	1
8	909-08	Air Filter	1
10	909-10	Valve Stem	1
11	909-11	"O" Ring	2
12	909-12	Valve Sleeve	1
13	909-13	Circlip	1
14	909-14	Valve Complete - On/Off	1
16	909-16	Hose Complete - 2 metre	1

ST-909-P-0608B-C1